



Walmington Fold, London, N12 7LR

£3,950 Per Week -

A fantastic 4/5 bedroom house located in this fantastic location within Woodside Park. Very large reception areas on the ground floor, including 2 reception areas and a dining room, L shaped kitchen, downstairs bedroom with en suite plus a downstairs WC. The top 2 floors have a further 4 bedrooms and 2 bathrooms, including one en suite. To the rear of the property is a good size garden and garage. Part furnished and available immediately

Council tax band G
Deposit £4557.69

- 4/5 bedrooms
- 3 bathrooms
- Downstairs WC
- Semi detached house
- Garage
- Council tax band G
- Part furnished
- Available immediately

Floor Plan

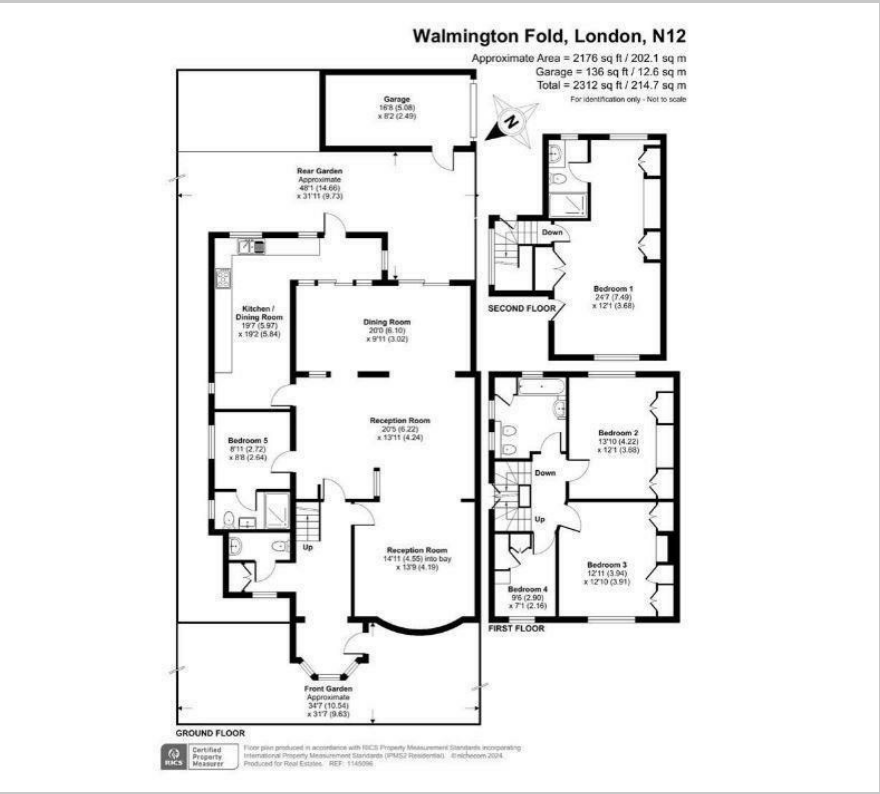

Area Map



Energy Efficiency Graph

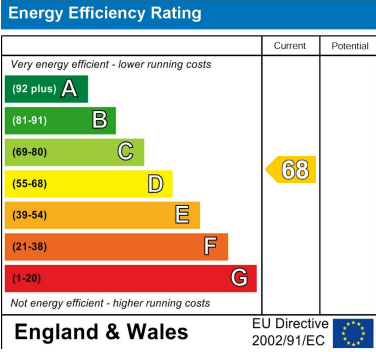

These particulars, whilst believed to be accurate are set out as a general outline only for guidance and do not constitute any part of an offer or contract. Intending purchasers should not rely on them as statements of representation of fact, but must satisfy themselves by inspection or otherwise as to their accuracy. No person in this firm's employment has the authority to make or give any representation or warranty in respect of the property.